

# AM.5.UD... MODULAR DIRECT CHECK VALVES CETOP 5



**AM.5.UD...**

SCREWS AND STUDS

CH. IV PAGE 36

AM5UD type modular check valves allow free flow in one direction, while a conical seated poppet prevents flow in the opposite direction. They are available on single A, B, P and T lines, and on double A and B, P and T lines (see hydraulic symbols).

1 bar springs are standard, while 5 bar rated springs are available on request.

Max. operating pressure	350 bar
Minimum opening pressure spring 1	1 bar
Minimum opening pressure spring 5	5 bar
Max. flow	80 l/min
Hydraulic fluids	Mineral oils DIN 51524
Fluid viscosity	10 ÷ 500 mm <sup>2</sup> /s
Fluid temperature	-25°C ÷ 75°C
Ambient temperature	-25°C ÷ 60°C
Max. contamination level	class 10 in accordance with NAS 1638 with filter $\beta_{25} \geq 75$
Weight	2,1 Kg

4

### ORDERING CODE

<b>AM</b>	Modular valve
<b>5</b>	CETOP 5/NG10
<b>UD</b>	Direct check valve
<b>**</b>	Control on lines <b>A / B / P / T / AB / PT</b>
<b>*</b>	Minimum opening pressure <b>1 = 1 bar</b> <b>5 = 5 bar</b>
<b>**</b>	<b>00 = No variant</b> <b>V1 = Viton</b>
<b>2</b>	Serial No.

### PRESSURE DROPS

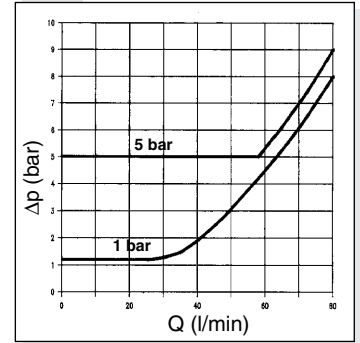

### OVERALL DIMENSIONS

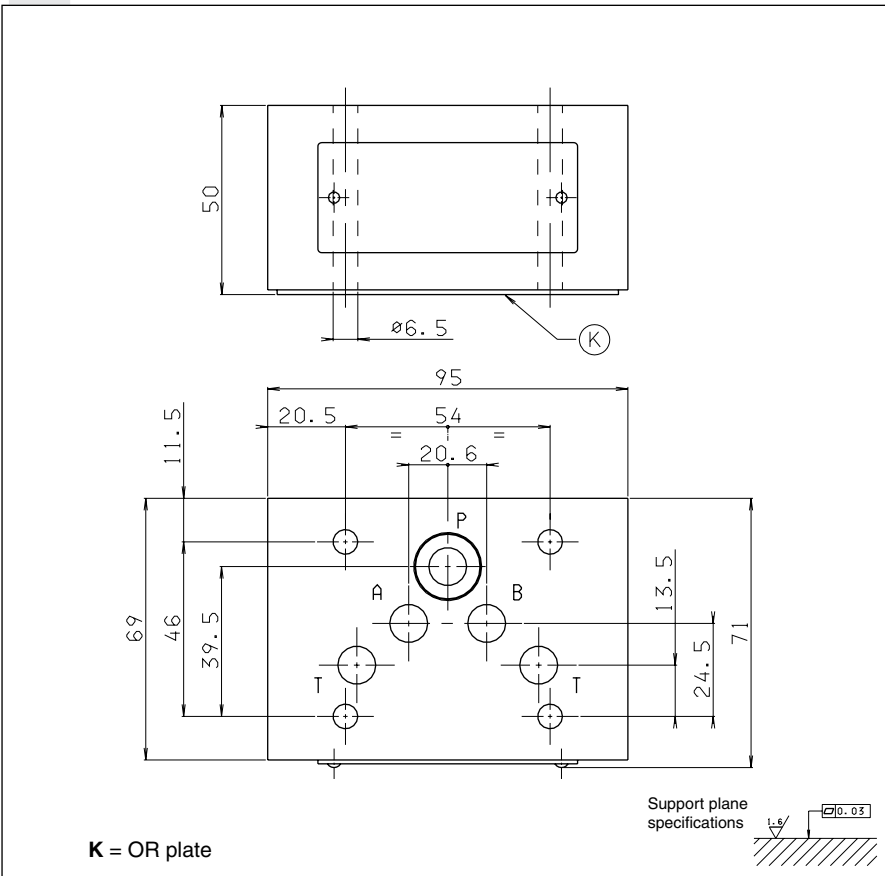

### HYDRAULIC SYMBOLS

