

**LMT302**

LMCCE-A01E-QSKG-2/US

Level sensors

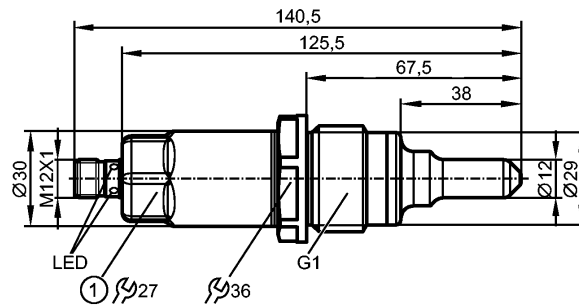

1: tightening torque 35 Nm



**Product characteristics**

Electronic level sensor
Quick disconnect
Process connection: G 1 A
Suited for installation in existing tuning fork adapters
Probe length: 38 mm
gold-plated contacts
Communication interface: IO-Link 1.1
2 switching outputs

**Application**

Application	liquid, viscous and powdery media
Recommended media	water, water-based media, oils, oil-based media, powdery media
Cannot be used for:	See the operating instructions, chapter "Function and features".

**Medium temperature oil**

- Continuous	[°C]	-20...100
- Short time	[°C]	-20...150 (1 h)

**Medium temperature water and hydrous media**

- Continuous	[°C]	-20...85
- Short time	[°C]	-20...150 (1 h)

**Electrical data**

Electrical design		DC PNP/NPN
Operating voltage	[V]	18...30 DC
Current consumption	[mA]	< 50
Protection class		III
Reverse polarity protection		yes

**Outputs**

Output		2 switching outputs
Output function		2 x normally open / closed programmable
Current rating	[mA]	100
Voltage drop	[V]	< 2.5
Short-circuit protection		yes (non-latching)
Overload protection		yes

**Measuring / setting range**

Factory setting		water-based media
-----------------	--	-------------------

**Interfaces**

## LMT302

LMCCE-A01E-QSKG-2/US

Level sensors

### IO-Link Device

Transfer type	COM2 (38.4 kBaud)
IO-Link revision	1.1
SDCI standard	IEC 61131-9
IO-Link Device ID	0x000172
Profiles	Smart Sensor: Process Data Variable; Device Identification
SIO mode	yes
Required master port class	A
Process data analogue	1
Process data binary	2
Min. process cycle time [ms]	2.3

### Environment

Ambient temperature [°C]	-20...85, at max. 100 °C medium temperature (-20...60 °C at max. 150 °C medium temperature)
Storage temperature [°C]	-40...85
Maximum vessel pressure [bar]	-1...40
Protection	IP 68 / IP 69K

### Tests / approvals

EMC	DIN EN 61000-6-2 : 2006 DIN EN 61000-6-4 : 2011 / (open tanks) DIN EN 61000-6-3 : 2011 / (closed tanks)
Shock resistance	DIN EN 60068-2-27 50 g (11 ms)
Vibration resistance	DIN EN 60068-2-6 20 g (10...2000 Hz)
MTTF [Years]	223
UL approval number	H001

### Mechanical data

Process connection	G 1 A
Materials (wetted parts)	PEEK; surface characteristics: Ra < 0.8
Housing materials	stainless steel (316L / 1.4404); PEEK; PEI; FKM
Weight [kg]	0.391

### Displays / operating elements

Display	Switching status LEDs yellow operating status LEDs green
---------	---

### Electrical connection

Connection	M12 connector; gold-plated contacts
------------	-------------------------------------

### Wiring

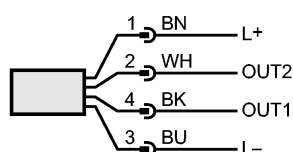

OUT1: Switching output / IO-Link / Teach  
OUT2: Switching output  
Colours to DIN EN 60947-5-2

### Remarks



**LMT302**

LMCCE-A01E-QSKG-2/US

**Level sensors**

Pack quantity [piece] 1