

Filtro olio idraulico in aspirazione Hydraulic oil suction filter

Codice Part number	øA	B	E	G	Area filtrante Filtration area (cm ²)	Materiale Material	Grado di filtrazione Filtration Ratio (micron)	Portata Flow (l/min)
MCRFR503546	63	16	6	1/4" BSP	30	Reps. Fe Zn	250	9
MCRFR103570	63	18	8	3/8" BSP	30	Lam. INOX	250	12
MCRFR502395	80	23	5	1/4" BSP	200	Reps Fe Zn	90	12
MCRFR102392	80	25	7	3/8" BSP	200	Reps Fe Zn	90	14

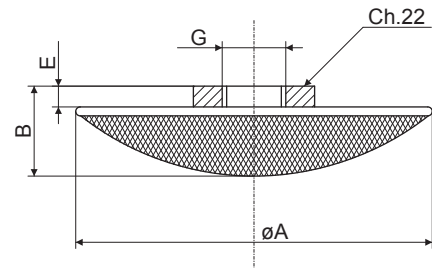

Filtro olio idraulico in aspirazione 1/4" GAS Hydraulic oil suction filter 1/4" gas

Codice Part number	øA	B	E	Area filtrante Filtration area (cm ²)	Materiale Material	Grado di filtrazione Filtration Ratio (micron)	Portata Flow (l/min)
MCRFR501759	32	27	6	34	Reps. Fe Zn	90	5

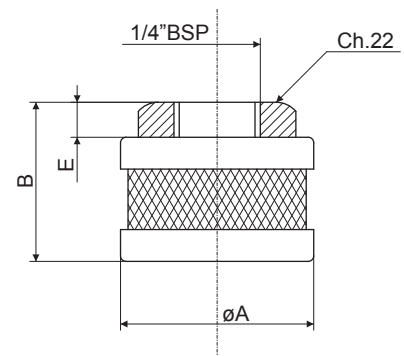

STAFFA FOOT FLANGE

MCR - Staffa

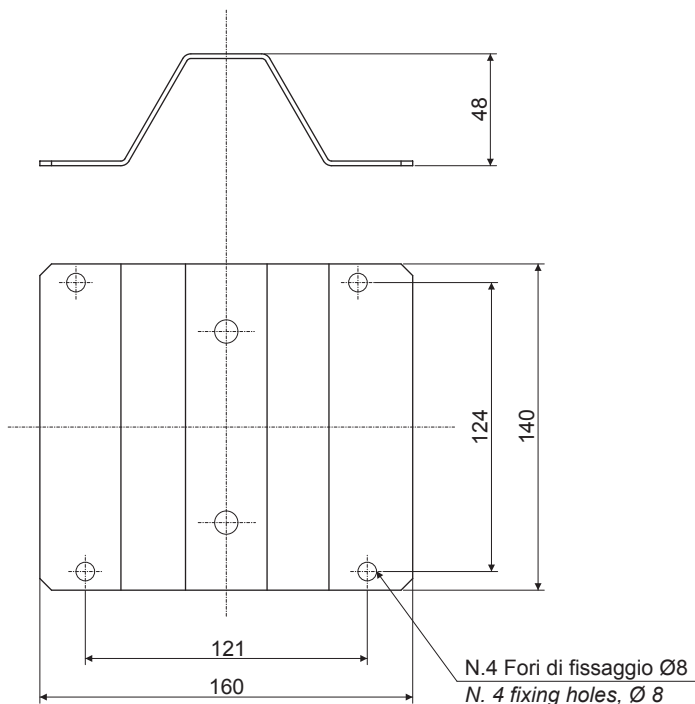

Per il fissaggio della staffa al blocco centrale utilizzare viti M8 x 12 UNI5739 rosetta elastica A 8,4 UNI1751.

To fix foot flange to central manifold use M8 x 12 UNI5739 screws + spring washer A 8,4 UNI1751

Filtri SF - F01 / Filters

Filtri specifici per questo utilizzo. In aspirazione **SF 46A-G0**.
 Grado di filtrazione 125 µm. Portata massima 15 l/min.
 Sul ritorno **F01**.

Grado di filtrazione 20 µm. Portata massima 20 l/min.
 Incorpora la valvola di by-pass

"SF" and "F01" filters. Suction and return filters specially
 designed for this application. Filtration on suction type SF is
 125 micron and flow up to 15 l/min.

On return the type F01 has flow up to 20 l/min and optional
 filtration 20 micron F01 filter has built in by-pass valve.

