

● ● ● ● ● ● **Прессуемый ниппель Waterblast / Waterblast tail**

Страница / Page **2** **2**

Ferrule
Воскола

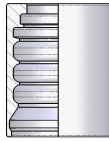

00S4

4 Spiral

Waterblast

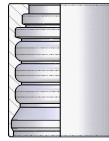

00S6

6 Spiral

Waterblast

Страница / Page **3** **3**

BSPF
Female

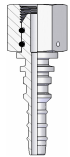

0050W

Ниппель BSP конус 60°

BSP Female 60° cone Thrust Wire

BSPM
Male

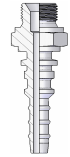

0350W

Штуцер BSP конус 60°

BSP Male Parallel 60° cone

Страница / Page **4** **4**

NPTF
Male

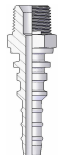

0370W

Штуцер NPTF конус 60°

NPTF Male 60° cone

DKOS
Female

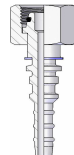

0084W

Ниппель метрический, конус 24° S

Metric Female 24° Seat Heavy

Dimensions and general characteristics may be changed at any time without prior notice.

Data contained herein are for information purpose only, and it does not enlarge, amend or imply any warranty other than provided by us with the product
Any use of the product not in conformance with our instructions may be dangerous.

00S4 **Муфта обжимная (зачистная)**

Swaged Ferrule (skive)

для рукава / for hose:
4 Spiral - Waterblast

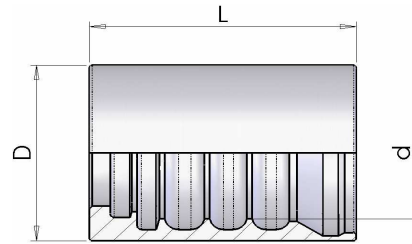

| part number | hose I.D. | | Dimension | | | skive | valid for |
|----------------|-----------|------|-----------|------|------|--------|-----------|
| | in | mm | D | L | d | length | |
| 00S4-06 | 3/8 | 9,5 | 28,0 | 45,5 | 20,0 | 30/14 | 4 spiral |
| 00S4-08 | 1/2 | 12,7 | 33,0 | 50,3 | 24,0 | 33/12 | 4 spiral |
| 00S4-12 | 3/4 | 19 | 41,0 | 56,0 | 32,0 | 42/15 | 4 spiral |

СНАРУЖИ/ВНУТРИ

00S6 **Муфта обжимная (зачистная)**

Swaged Ferrule (skive)

для рукава / for hose:
6 Spiral - Waterblast

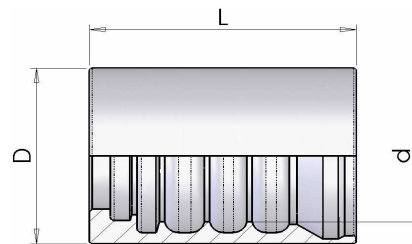

| part number | hose I.D. | | Dimension | | | skive | valid for |
|----------------|-----------|------|-----------|------|------|--------|-----------|
| | in | mm | D | L | d | length | |
| 00S6-06 | 3/8 | 9,5 | 30,0 | 45,5 | 22,0 | 30/14 | 6 spiral |
| 00S6-08 | 1/2 | 12,7 | 36,0 | 50,3 | 27,0 | 33/12 | 6 spiral |
| 00S6-12 | 3/4 | 19 | 44,0 | 56,0 | 35,0 | 42/15 | 6 spiral |
| 00S6-16 | 1 | 25,4 | 55,0 | 67,2 | 43,7 | 47/18 | 6 spiral |

СНАРУЖИ/ВНУТРИ

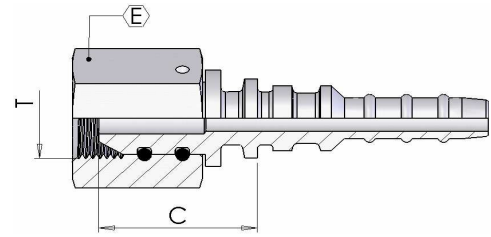
0050W Ниппель BSP конус 60°
(DKR) BSP Female 60° cone Thrust Wire

| part number | hose I.D. | | Dimension | | | |
|-------------------|-----------|------|-----------|--------|-----|---------|
| | | | dash size | thread | hex | cut-off |
| | in | mm | | T | E | C |
| 0050W08-08 | 1/2 | 12,7 | 08 | 1/2-14 | 30 | 32 |
| 0050W12-12 | 3/4 | 19 | 12 | 3/4-14 | 32 | 37 |
| 0050W16-16 | 1 | 25,4 | 16 | 1-11 | 38 | 40 |

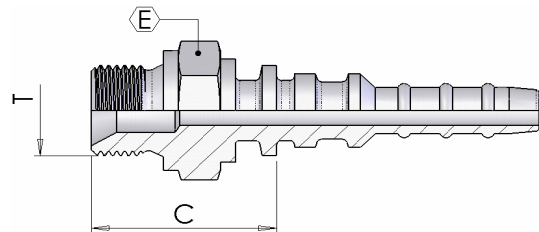
0350W Штуцер BSP конус 60°
(AGR) BSP Male Parallel 60° cone

| part number | hose I.D. | | Dimension | | | |
|-------------------|-----------|------|-----------|--------|-----|---------|
| | | | dash size | thread | hex | cut-off |
| | in | mm | | T | E | C |
| 0350W08-08 | 1/2 | 12,7 | 08 | 1/2-14 | 27 | 36 |
| 0350W12-12 | 3/4 | 19 | 12 | 3/4-14 | 32 | 39 |
| 0350W16-16 | 1 | 25,4 | 16 | 1-11 | 41 | 44 |

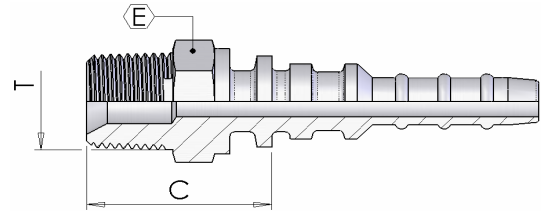
0370W Штуцер NPTF конус 60°
(AGN) NPTF Male 60° cone

| part number | hose I.D. | | Dimension | | | |
|-------------------|-----------|------|-----------|----------|-----|---------|
| | | | dash size | thread | hex | cut-off |
| | in | mm | | T | E | C |
| 0370W06-06 | 3/8 | 9,5 | 06 | 3/8-18 | 19 | 30 |
| 0370W08-08 | 1/2 | 12,7 | 08 | 1/2-14 | 22 | 38 |
| 0370W12-12 | 3/4 | 19 | 12 | 3/4-14 | 27 | 41 |
| 0370W16-16 | 1 | 25,4 | 16 | 1-11.1/2 | 48 | 44 |

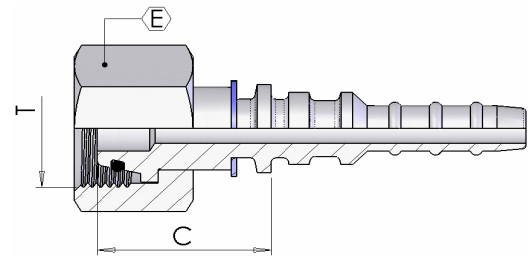
0084W Ниппель метрический, конус 24°, S
(DKOS) Metric Female 24° Seat Heavy

| part number | hose I.D. | | Dimension | | | | |
|-------------------|-----------|------|-----------|---------|------|-----|---------|
| | | | dash size | thread | erm. | hex | cut-off |
| | in | mm | | T | | E | C |
| 0084W06-20 | 3/8 | 9,5 | 06 | M20-1.5 | 12 | 24 | 29 |
| 0084W06-22 | 3/8 | 9,5 | 06 | M22-1.5 | 14 | 27 | 31 |
| 0084W06-24 | 3/8 | 9,5 | 08 | M24-1.5 | 16 | 30 | 33 |
| 0084W08-24 | 1/2 | 12,7 | 08 | M24-1.5 | 16 | 30 | 33 |
| 0084W12-36 | 3/4 | 19 | 12 | M36-2 | 25 | 46 | 43 |