



**INDICATORI
DI PRESSIONE**

MGE.B

PRESSURE GAUGES
STAINLESS STEEL CASE (GLYCERINE)
BOTTOM + WALL FLANGE

PRESSURE GAUGES SUITABLE FOR ALL
PROCESS GASEOUS AND LIQUID THAT
DON'T ATTACK COPPER ALLOY PARTS.
INTENDED FOR ADVERSE SERVICE
CONDITIONS WHERE PULSATING OR
VIBRATION EXIST SERVICE CONDITIONS
WHERE PULSATING OR VIBRATION EXISTS.
MADE ACCORDING UNI EN 837.1
NORMS.



TECHNICAL DATA

DIAL	40 - 50 - 63 - 80 - 100 - 150 MM	
THREAD CONNECTION	DIAL 40 MM - 1/8" BSPT	
	DIAL 50, 63, 80 - 1/4" BSPP	
	DIAL 100, 150 - 1/2" BSPP	
ACCURACY	DIAL 40, 50 - 2,5%	
	DIAL 63 - 1,6%	
	DIAL 80, 100, 150 - 1%	
WORKING TEMPERATURE	-10 +60 °C (+14 +140 °F)	
WORKING PRESSURE	STEADY	75% OF THE SCALE
	VARIABLE	60% OF THE SCALE
OVERPRESSURE	25% < 60 BAR > 15% (ACCORDING EN873.1)	

MODELS

VACUUM	COMPOUND	MANOMETR
-1 - 0 BAR+CMHG		0,6
		1
		1,6
		2,5
		4
		6
		10
		16
		25
		40
		60
		100
		160
		250
		315
	400	
	600	
	1000	
	BAR+Psi	

MGE.B

PRESSURE GAUGES
STAINLESS STEEL CASE (GLYCERINE)
BOTTOM + WALL FLANGE

INDICATORI
DI PRESSIONE



INSTALLATION DIMENSIONS

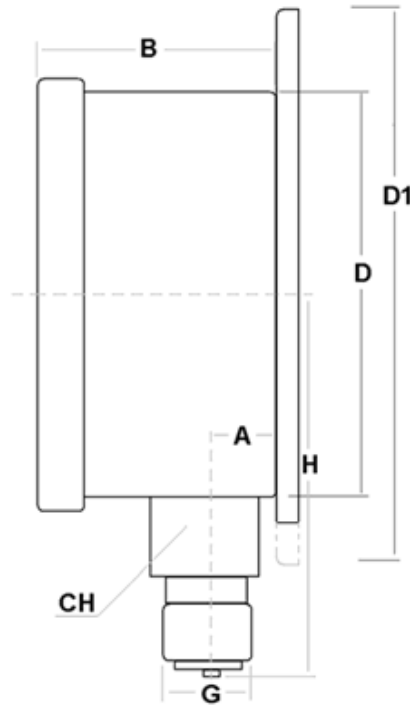

DIAL	A	B	D	D1	H	G	CH	WEIGHT (KG)
63	10	29	62	83	53	1/4" BSPP	14	0,19
100	10	38	98,5	128	82	1/2" BSPP	22	0,79

- STAINLESS STEEL CASE;
- PROTECTION DEGREE - IP65;
- BRASS SPRING, MOVEMENT AND PIVOT;
- ALUMINIUM INDEX;
- ALUMINIUM DIAL;
- WHITE BACKGROUND;
- BLACK BAR SCALE AND RED PSI (EXCEPT COMPOUND GAUGE).



**INDICATORI
DI PRESSIONE**

MGE.B

PRESSURE GAUGES
STAINLESS STEEL CASE (GLYCERINE)
BOTTOM + WALL FLANGE

ORDER CODE

	B		MGE
--	----------	--	------------

DIAL

- 40=40 MM
- 50=50 MM
- 63=63 MM
- 80=80 MM
- 100=100 MM
- 150=150 MM

B=BOTTOM + WALL FLANGE

PRESSURE RANGE

- 1-0=-1 - 0 BAR+CMHG
- 1 +0,6=-1 - +0,6 BAR
- 1 +1,5=-1 - +1,5 BAR
- 1 +3=-1 - +3 BAR
- 1 +5=-1 - +5 BAR
- 1 +9=-1 - +9 BAR
- 1 +15=-1 - +15 BAR

- 0,6=0 - 0,6, BAR+PSI
- 1=0 - 1, BAR+PSI
- 1,6=0 - 1,6, BAR+PSI
- 2,5=0 - 2,5, BAR+PSI
- 4=0 - 4, BAR+PSI
- 6=0 - 6, BAR+PSI
- 10=0 - 10, BAR+PSI
- 16=0 - 16, BAR+PSI
- 25=0 - 25, BAR+PSI
- 40=0 - 40, BAR+PSI
- 60=0 - 60, BAR+PSI
- 100=0 - 100, BAR+PSI
- 160=0 - 160, BAR+PSI
- 250=0 - 250, BAR+PSI
- 315=0 - 315, BAR+PSI
- 400=0 - 400, BAR+PSI
- 600=0 - 600, BAR+PSI
- 1000=0 - 1000, BAR+PSI