



PN009A

PN-0-1BRBR14-MFPKG/US/3D IV



Pressure sensors

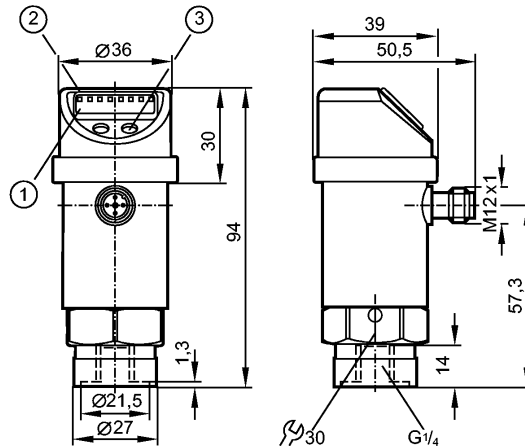

- 1: 4-digit alphanumeric display
- 2: LEDs (display unit / switching status)
- 3: Programming button



Product characteristics

Combined pressure sensor

Quick disconnect

Function programmable

ATEX approval

Group II, category 3D

Process connection: G 1/4 I

Switching output, Analog output

4-digit alphanumeric display

Measuring range: -1000...0 mbar

Application

Application	Type of pressure: relative pressure Liquids and gases	
Pressure rating [mbar]	10000	
Bursting pressure min. [mbar]	30000	
Medium temperature [°C]	-20...60	

Electrical data

Electrical design	DC PNP	
Operating voltage [V]	18...36 DC ¹⁾	
Current consumption [mA]	< 50	
Protection class	III	
Reverse polarity protection	yes	
Overvoltage protection [V]	up to 40 V	

Outputs

Output	Switching output, Analog output	
Output function	normally open / closed programmable; 4...20 mA or 0...10 V	
Current rating [mA]	250	
Voltage drop [V]	< 2	
Short-circuit protection	yes (non-latching)	
Switching frequency [Hz]	≤ 170	



PN009A

PN-0-1BRBR14-MFPKG/US/3D /V



Pressure sensors

Analog output	4...20 mA / 0...10 V
Max. load [Ω]	4...20 mA: max. 500 / 0...10 V: min. 2000

Measuring / setting range

Display unit	mbar, kPa, psi, inHg
Measuring range [mbar]	-1000...0
Setting range	
Set point, SP [mbar]	-990...0
Reset point, rP [mbar]	-995...-5
in steps of [mbar]	5
Factory setting	SP1 = -750 mbar; rP1 = -770 mbar

Accuracy / deviations

Accuracy / deviations (in % of the span)	
Switch point accuracy	< ± 0.5
Characteristics deviation *)	< ± 0.25 (BFSL) / < ± 0.5 (LS)
Hysteresis	< ± 0.25
Repeatability **)	< ± 0.1
Long-term stability ***)	< ± 0.05
Temperature coefficients (TEMPCO) in the temperature range 0...60° C (in % of the span per 10 K)	
Greatest TEMPCO of the zero point	0.2
Greatest TEMPCO of the span	0.2

Reaction times

Power-on delay time [s]	0.3
Delay time programmable dS, dr [s]	0; 0.2...50
Response time analog output [ms]	< 3
Integrated watchdog	yes

Software / programming

Programming options	hysteresis / window function; N.O. / N.C; on delay, off delay; damping; display unit; current / voltage output
Adjustment of the switch point	Programming button

Environment

Ambient temperature [°C]	-20...60
Storage temperature [°C]	-40...100
Protection	IP 65

Tests / approvals

Marking of the unit	Ex II 3D Ex tc IIIC T80°C Dc X
EMC	EN 61000-4-2 ESD: 4 kV CD / 8 kV AD EN 61000-4-3 HF radiated: 10 V/m EN 61000-4-4 Burst: 2 kV EN 61000-4-5 Surge: 0.5/1 kV EN 61000-4-6 HF conducted: 10 V
Shock resistance	DIN IEC 68-2-27: 50 g (11 ms)
Vibration resistance	DIN IEC 68-2-6: 20 g (10...2000 Hz)
MTTF [Years]	213

Mechanical data

Process connection	G ¼ I
--------------------	-------



PN009A

PN-0-1BRBR14-MFPKG/US/3D IV

Pressure sensors

Materials (wetted parts)	stainless steel (303S22); ceramics; FPM (Viton)
Housing materials	stainless steel (304S15); stainless steel 316L / 1.4404; PC (Makrolon); PBT (Pocan); PEI; FPM (Viton); PTFE
Switching cycles min.	100 million
Weight [kg]	0.305

Displays / operating elements

Display	Display unit 4 x LED green Switching status LED yellow Function display 4-digit alphanumeric display Measured values 4-digit alphanumeric display
---------	--

Electrical connection

Connection	M12 connector; gold-plated contacts
------------	-------------------------------------

Wiring

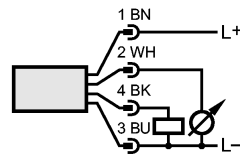

Remarks

Remarks	1) to EN50178, SELV, PELV *) BFSL = Best Fit Straight Line / LS = Limit Value Setting **) with temperature fluctuations < 10 K ***) in % of value of measuring range / 6 months
---------	--

Pack quantity [piece]	1
-----------------------	---