

RF

Screw to connect couplings for air conditioning & refrigeration application

This range of couplings has been specifically designed for air conditioning and refrigeration systems. Interchangeability according to market driven standards. Available in several versions in steel, brass and with copper sweat braise adaptor.

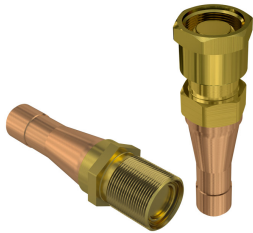

Applications

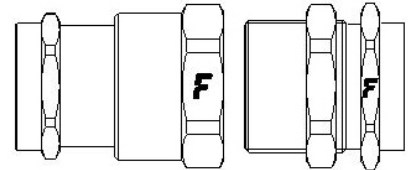

Seals	CR
Material	Brass & Steel
Valve Type	Flat
Working temperatures	-40 °C to 120 °C
Surface treatment	MATE 500 (CrIII)
Series Interchange	MARKET
Connection	Screw to Connect
Disconnection	Unscrew to Disconnect
Connection Under Pressure	Allowed Residual

Pressure Drop

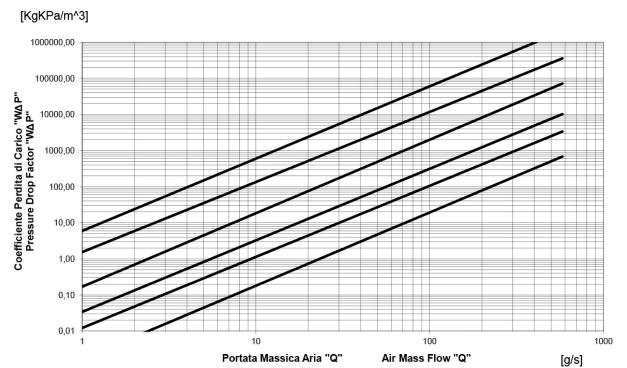

Data shown in the diagram are indicative and not binding. KgKPa/m³. Dash size are specified.