

TA2303

TA-030FLEN12-A-ZVG/US

Temperature sensors

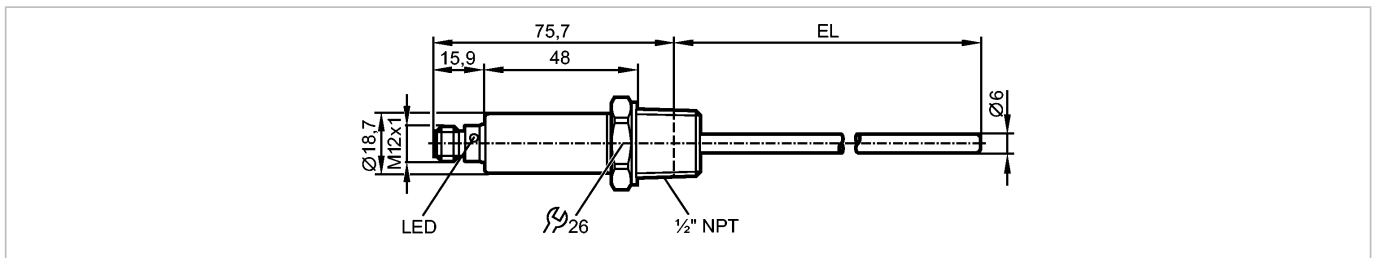

Product characteristics

Temperature transmitter
Quick disconnect
Process connection: 1/2" NPT
Installation length EL: 30 mm
Analog output 4...20 mA
Measuring range: -58...302 °F
Measuring element: 1 x Pt 1000, to DIN EN 60751, class A
Factory setting: 0...300 °F

Application

Application	liquids and gases
Pressure rating [bar]	300; only applies to the sensor; for installation in adapters the indications in the adapter data sheet shall apply

Electrical data

Electrical design	DC
Operating voltage [V]	18...32 DC; cULus - Class 2 source required
Current consumption [mA]	< 50
Protection class	III
Reverse polarity protection	yes

Outputs

Output function	4...20 mA analog
Short-circuit protection	yes
Overload protection	yes
Analog output	4...20 mA
Max. load [Ω]	250 (18...19 V); 300 (19...32 V)

Measuring / setting range

Measuring range °F	-58...302
Factory setting	0...300 °F
Resolution	
Analog output [K]	≤ 0.04

Accuracy / deviations

Analog output [K]	± 0.3 + (± 0.1 % MS)
Temperature coefficients (in % of the span per 10 K)	0.1

Reaction times

Power-on delay time [s]	1
Dynamic response T05 / T09 [s]	1 / 3

TA2303

TA-030FLEN12-A-ZVG/US

Temperature sensors

Interfaces

IO-Link Device	
Transfer type	COM2 (38.4 kBaud)
IO-Link revision	1.1

Environment

Ambient temperature	[°C]	-25...80
Storage temperature	[°C]	-40...100
Protection		IP 67 / IP 68 / IP 69K

Tests / approvals

EMC		DIN EN 61000-6-2
Shock resistance	DIN IEC 68-2-27:	50 g (11 ms)
Vibration resistance	DIN IEC 68-2-6:	20 g (10...2000 Hz)
MTTF	[Years]	572
UL approval number		K002

Mechanical data

Process connection		½" NPT
Materials (wetted parts)		stainless steel 316L / 1.4404; O-ring: FKM
Probe diameter	[mm]	6
Installation length EL	[mm]	30
Housing materials		stainless steel 316L / 1.4404; PEI; FKM
Weight	[kg]	0.121

Displays / operating elements

Display		operating status 1 x LED green
---------	--	--------------------------------

Electrical connection

Connection		M12 connector; gold-plated contacts
------------	--	-------------------------------------

Wiring

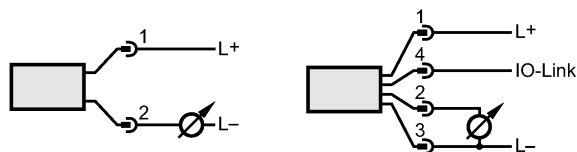

Remarks

Remarks		MS = set measuring span
Pack quantity	[piece]	1