



# TM5411

TM-050KCBR12- /US/



Temperature sensors

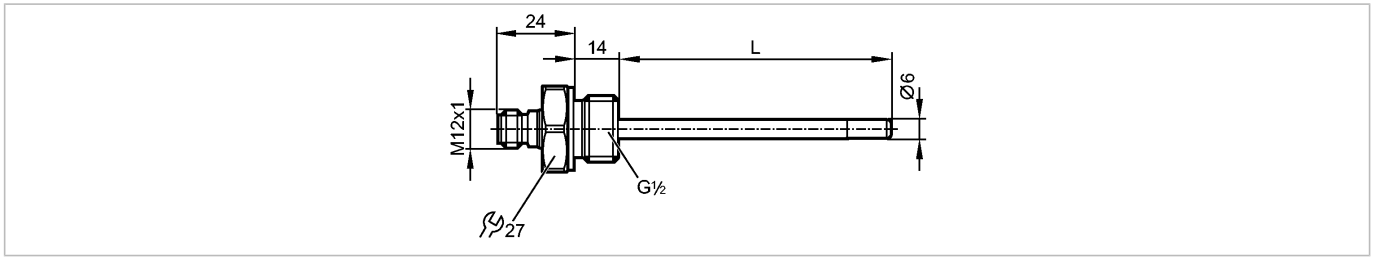

## Product characteristics

Temperature sensor for connection to a control monitor with a max. operating voltage of 32 V

Quick disconnect

Process connection: G 1/2

Installation length EL: 50 mm

gold-plated contacts

Connection to control monitor TP / TR

Measuring range: -40...150 °C / -40...302 °F

Measuring element: 1 x Pt 1000, to DIN EN 60751, class A

## Application

Application	liquids and gases
Pressure rating [bar]	160
Minimum installation depth [mm]	15

## Electrical data

Connection to control monitor	TP / TR
Protection class	III

## Measuring / setting range

Measuring range	-40...150 °C	-40...302 °F
-----------------	--------------	--------------

## Accuracy / deviations

Accuracy	$\pm (0.15 \text{ K} + 0.002 \times  t )$
----------	---

## Reaction times

Dynamic response T05 / T09 [s]	1 / 3 *)
--------------------------------	----------

## Environment

Ambient temperature [°C]	-25...80
Storage temperature [°C]	-40...100
Protection	IP 68 / IP 69K

## Tests / approvals

Shock resistance	DIN EN 60068-2-2-27:	50 g (11 ms)
Vibration resistance	DIN EN 60068-2-6	10 g (10...2000 Hz)
UL approval number		K004

## Mechanical data

Process connection	G 1/2
Materials (wetted parts)	stainless steel 316L / 1.4404; FPM (Viton)
Probe diameter [mm]	6
Probe length L [mm]	36
Installation length EL [mm]	50
Housing materials	stainless steel 316L / 1.4404



# TM5411

TM-050KCBR12- /US/



Temperature sensors

Weight [kg] 0.124

## Electrical connection

Connection M12 connector; gold-plated contacts

### Wiring

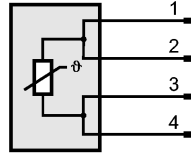

## Remarks

Remarks cULus - Class 2 source required  
\*) according to DIN EN 60751  
The values for accuracy apply to flowing water.

Pack quantity [piece] 1