

TM9950

TM-045-BEM18 /US

Temperature sensors

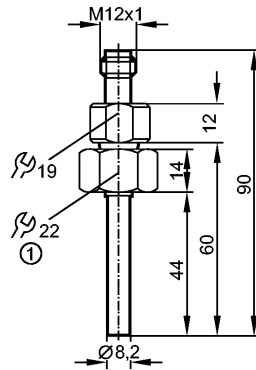

1: internal thread M18 x 1.5



Product characteristics

Temperature sensor for connection to a control monitor with a max. operating voltage of 32 V

Quick disconnect

Process connection: internal thread M18 x 1.5 for adapter

Installation length EL: 60 mm

gold-plated contacts

Connection to control monitor TP / TR

Measuring range: -40...125 °C / -40...257 °F

Measuring element: 1 x Pt 100, to DIN EN 60751, class B

Application

Application liquids and gases

Pressure rating [bar] 300

Minimum installation depth [mm] 15

Electrical data

Connection to control monitor TP / TR

Protection class III

Measuring / setting range

Measuring range -40...125 °C -40...257 °F

Accuracy / deviations

Accuracy ± (0.30 K + 0.005 x |t|)

Reaction times

Dynamic response T05 / T09 [s] 1 / 3 *)

Environment

Ambient temperature [°C] -25...80

Protection IP 68 / IP 69K

Tests / approvals

MTTF [Years] 22831

Mechanical data

Process connection internal thread M18 x 1.5 for adapter

Materials (wetted parts) stainless steel 316L / 1.4404

Probe diameter [mm] 8.2

Probe length L [mm] 44

Installation length EL [mm] 60



TM9950

TM-045-BEM18 /US

Temperature sensors

Housing materials	stainless steel 316L / 1.4404
Weight [kg]	0.082

Electrical connection

Connection	M12 connector; gold-plated contacts
------------	-------------------------------------

Wiring

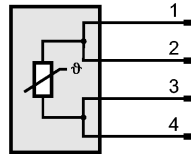

Remarks

Remarks	cULus - Class 2 source required *) according to DIN EN 60751 The values for accuracy apply to flowing water.
---------	--

Pack quantity [piece]	1
-----------------------	---