



# TS325A

TS-300KEKD06...../3M/3D/3G



Temperature sensors

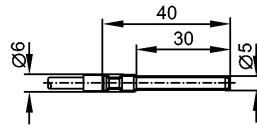

## Product characteristics

Temperature sensor for connection to evaluation units

Ø 5 mm

Cable

ATEX approval

Group II, category 3D/3G

Measuring range: -20...80 °C / -4...176 °F, Measuring range for non-ATEX applications: -20...180 °C / -4...356 °F

Measuring element: 1 x Pt 100, to DIN EN 60751, class B, operating current max. 10 mA

## Application

Application liquids and gases

Minimum installation depth [mm] 15

## Electrical data

Protection class III

## Measuring / setting range

Measuring range -20...80 °C -4...176 °F

Measuring range for non-ATEX applications -20...180 °C / -4...356 °F

## Accuracy / deviations

Accuracy  $\pm (0.30 \text{ K} + 0.005 \times |t|)$

## Reaction times

Dynamic response T05 / T09 [s] 4 / 10 \*)

## Environment

Ambient temperature [°C] -20...80

Protection IP 67

## Tests / approvals

Marking of the unit  $\text{Ex}$  II 3D Ex tc IIIC T100°C Dc X  
 $\text{Ex}$  II 3G Ex nA IIC T5 Gc X

MTTF [Years] 19348

## Mechanical data

Materials (wetted parts) stainless steel 316L / 1.4404

Probe diameter [mm] 5 / 6

Housing materials stainless steel 316L / 1.4404

Weight [kg] 0.088

## Electrical connection

Connection silicone cable / 3 m

## Wiring



# TS325A

TS-300KEKD06...../3M/3D/3G



Temperature sensors

### Core colors

WH white  
 BK black  
 RD red

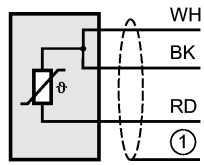

1 = screen (not connected to the housing)

### Remarks

Remarks

\*) according to DIN EN 60751  
 The values for accuracy apply to flowing water.

Pack quantity

[piece]

1