

# Throttle valve type MG

NS 6 - 30 |  $p_{max}$  35 MPa |  $Q_{max}$  400 dm<sup>3</sup>/min | WK 496 290



## DATA SHEET - OPERATION MANUAL

### APPLICATION

Throttle valves type MG... are used to throttle fluid flow which depends on a pressure difference at the throttle point and on viscosity of the fluid. They can be used in hydraulic systems where a constant working resistance occurs or change of speed under variable load is of no importance. The valves are suitable for mounting on pipelines in any position.

### DESCRIPTION OF OPERATION

Fluid is provided through the side bores **1** in the body **2** to the throttle point **3** between the body and the adjustable sleeve **4**. Through rotation of the sleeve **4** one can steplessly change circular cross-section of the throttle point **3**. Throttle is performed in both directions of the flow.

#### Caution:

When installing the valve in a hydraulic system, hold the valve by its hexagonal body **2**. Do not tighten the valve by means of the sleeve **4**. **Do not adjust under pressure!**



MG6 G15

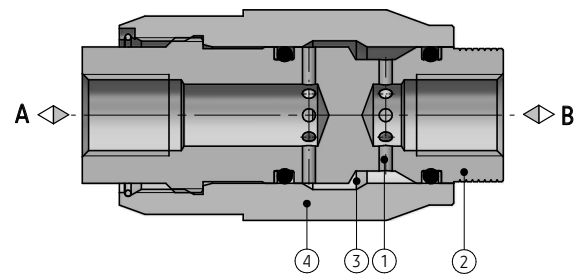

### TECHNICAL PARAMETERS

hydraulic fluid	mineral oil
required filtration	up to 16 $\mu$ m
recommended filtration	up to 10 $\mu$ m
nominal viscosity of the fluid	37 mm <sup>2</sup> /s at temp 55 °C
viscosity range	2,8 ÷ 380 mm <sup>2</sup> /s
fluid temperature range (in tank)	max. -20 ÷ 70 °C; recommend 40÷55 °C
ambient temperature range	-20 ÷ 70 °C
maximum operating pressure	35 MPa
weight	0,30 ÷ 4,1 kg (details on page 2)

assembly and operation requirements at [www.operating-conditions.ponar.pl](http://www.operating-conditions.ponar.pl)

### HYDRAULIC DIAGRAMS

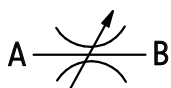

### PERFORMANCE CURVES

measured at viscosity  $\nu = 41 \text{ mm}^2/\text{s}$  and  $t = 50 \text{ }^\circ\text{C}$

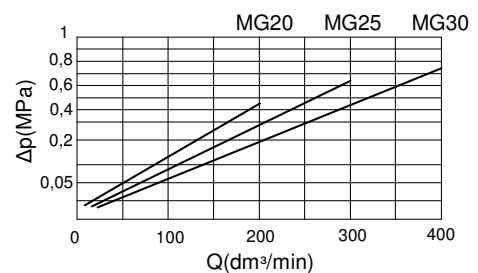
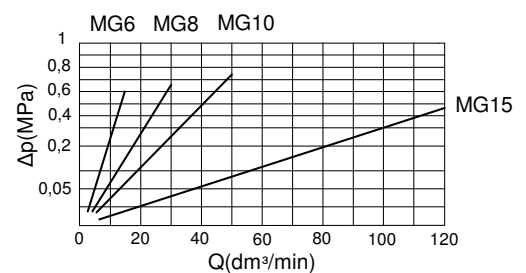

## OVERALL DIMENSIONS

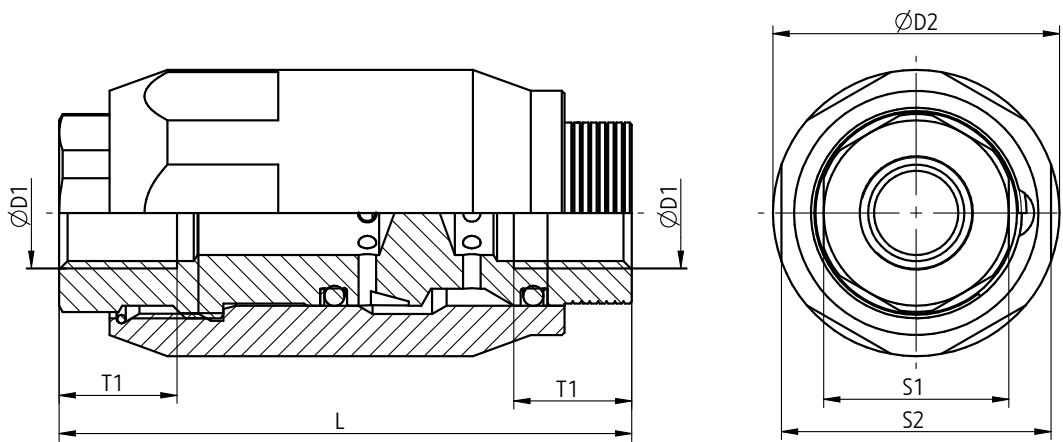

Size	ØD1	ØD2	L	S1	S2	T1	Weight (kg)
MG6...	G $\frac{1}{4}$	34	68	22	32	14	0,3
MG8...	G $\frac{3}{8}$	38	66	24	36	12,5	0,4
MG10...	G $\frac{1}{2}$	48	80	30	46	14	0,7
MG15...	G $\frac{3}{4}$	58	97	36	55	16	1,1
MG20...	G1	72	113	46	70	18	1,9
MG25...	G1 $\frac{1}{4}$	87	129	55	85	20	3,2
MG30...	G1 $\frac{1}{2}$	93	145	60	90	22	4,1

## HOW TO ORDER

Orders coded in the way showed below should be forwarded to the manufacturer.

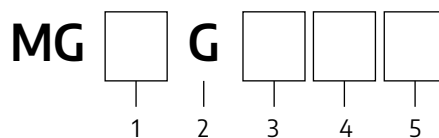

### 1 nominal size (NS)

WN6 =	6
WN8 =	8
WN10 =	10
WN15 =	15
WN20 =	20
WN25 =	25
WN30 =	30

### 2 mounting

Direct in-line mounting = G

### 3 series number

(10-19) - installation and connection dimensions remain unchanged = 1X  
 series 15 = 15

### 4 sealing

NBR (for fluids on mineral oil base) = Ø  
 FKM (for fluids on phosphate ester base) = V

### 5 further requirements = \*

(to be agreed with the manufacturer)

Ø indicates that the box should be left blank

Coding example: MG 6 G 15

## CONTACT

PONAR Wadowice S.A.  
 ul. Wojska Polskiego 29  
 34-100 Wadowice

phone +48 33 488 21 00  
 www.ponar-wadowice.pl