

TM/M

METAL PLUGS WITH PERMANENT MAGNET



Consisting of a milled hexagonal head and crown in light aluminium alloy, the metal plug with magnet (which can also be used as a normal tank drain plug) can catch the metal particles present in the oil.

- Seal ensured by a gasket with oilproof plain washer.
- Permanent magnet in cobalt alloy.
- For adequate quantities they can be supplied with materials and special executions to customer design.

PERMANENT MAGNET

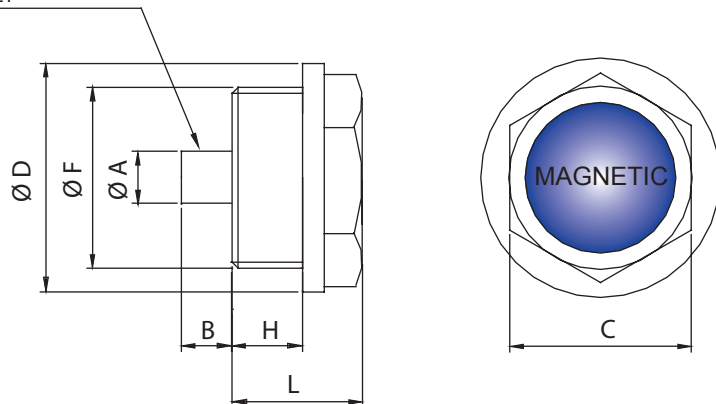

| GAS TYPE | F | C | D | H | L | A | B |
|-----------------|----------|----|----|------|------|----|----|
| TM / M 1/4" GAS | 1/4" GAS | 17 | 20 | 9 | 16 | 6 | 6 |
| TM / M 3/8" GAS | 3/8" GAS | 18 | 22 | 9 | 17 | 8 | 6 |
| TM / M 1/2" GAS | 1/2" GAS | 22 | 28 | 9 | 17 | 10 | 8 |
| TM / M 3/4" GAS | 3/4" GAS | 27 | 35 | 10 | 19 | 12 | 11 |
| TM / M 1" GAS | 1" GAS | 34 | 42 | 12,5 | 23,5 | 25 | 13 |
| METRIC TYPE | F | C | D | H | L | A | B |
| TM / M 14x1,5 | M 14x1,5 | 17 | 20 | 9 | 17 | 6 | 6 |
| TM / M 16x1,5 | M 16x1,5 | 18 | 22 | 9 | 17 | 8 | 7 |
| TM / M 18x1,5 | M 18x1,5 | 20 | 26 | 9 | 17 | 8 | 6 |
| TM / M 20x1,5 | M 20x1,5 | 22 | 28 | 9 | 17 | 10 | 8 |
| TM / M 22x1,5 | M 22x1,5 | 22 | 28 | 9 | 17 | 10 | 8 |